

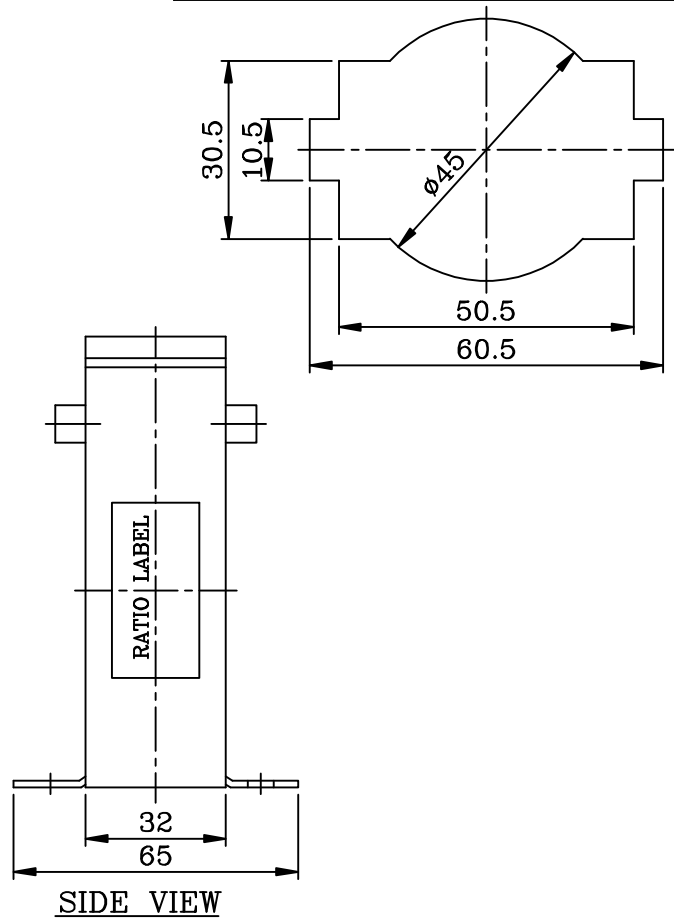

ABS CASING BOX TYPE BAR PRIMARY METERING CT.

| | |
|--------------|-------------------------------------|
| Type | ABS CASING BAR PRIMARY METERING CT. |
| Availability | ON ORDERING |

| | |
|--------------------------------------|----------------------|
| General Specifications | |
| Standards | IS 2705, IEC 60044-1 |
| Insulation Class | E (120° C) |
| Maximum Service voltage | 0.66 kV |
| Frequency | 50/60 Hz |
| Insulation Level : 3 kv for 1 minute | |
| S.T.C. Rating : 50 KArms For 1 Sec. | |

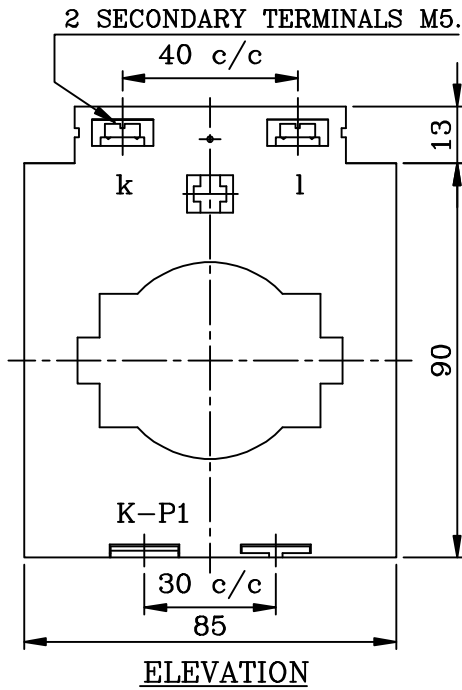
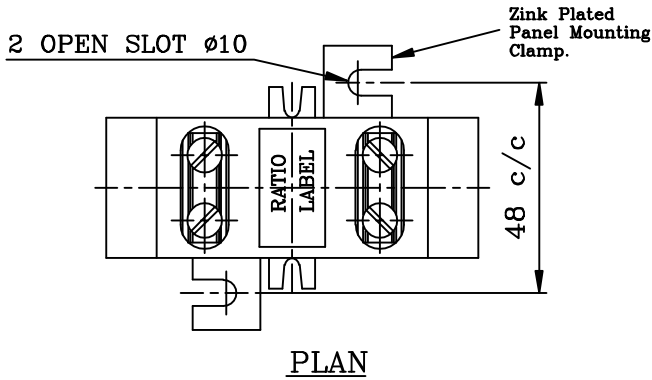

Features:

1. Din Rail Fitting Arrangement.
2. Panel Mounting Clamp Arrangement.
3. Cable / Busbar Holding Clamps.
4. Ultrasonically welded ABS FR Grade Casing.
5. Light Weight .
6. Low Price.

| S.R. No | Primary (Amp) | Secondary : 1 Amp & 5 Amp | |
|---------|---------------|---------------------------|----------------|
| | | Burden VA | Accuracy Class |
| 1 | 400 | 10 | 1 |
| 2 | 500 | 5/10 | 0.5/1 |
| 3 | 600 | 5/10 | 0.5/1 |
| 4 | 750 | 5/10 | 0.5/1 |
| 5 | 800 | 5/10 | 0.5/1 |
| 6 | 1000 | 5/10 | 0.5/1 |
| 7 | 1200 | 10/15 | 0.5/1 |
| 8 | 1250 | 10/15 | 0.5/1 |

DATE : 21/05/09. REV. : 0



RECO TRANSFORMERS
PVT. LTD.
LONAVALA - 410401.

PROJECTION

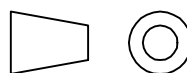

NAME :
ABS CASING BOX TYPE CT.

DRG. NO. : REC - 05